



Apx. House Dimensions:

Adverage Stage Dimensions :

40' Wide x 30' Deep x 20' Ceiling

Apron: 9' x 39' Apx.

PROSCENIUM:

WIDTH:	46'11"
Depth:	3'
Height at Center:	27'9"
Height at Nook:	21'4"
Height at Low Point:	18'9"

Stage level to:

House floor	3' 8"
second floor lock rail	26' 7"
loading gallery	60' 8"
grid iron	63' 9"

Plaster line to:

back of house orchestra	106' 0"
back of house balcony	111' 0"
downstage edge of apron	4' 0"
downstage edge of orch pit	15' 9"
upstage wall	35' 3"
last upstage line set	34' 5"
box booms	61' 0"
balcony rail	59' 9"
sound booth	103' 0"
coves	95'

Center line to:

locking rail - stage left	32' 3"
stage right wall	35' 2"
company switch	35' 0"

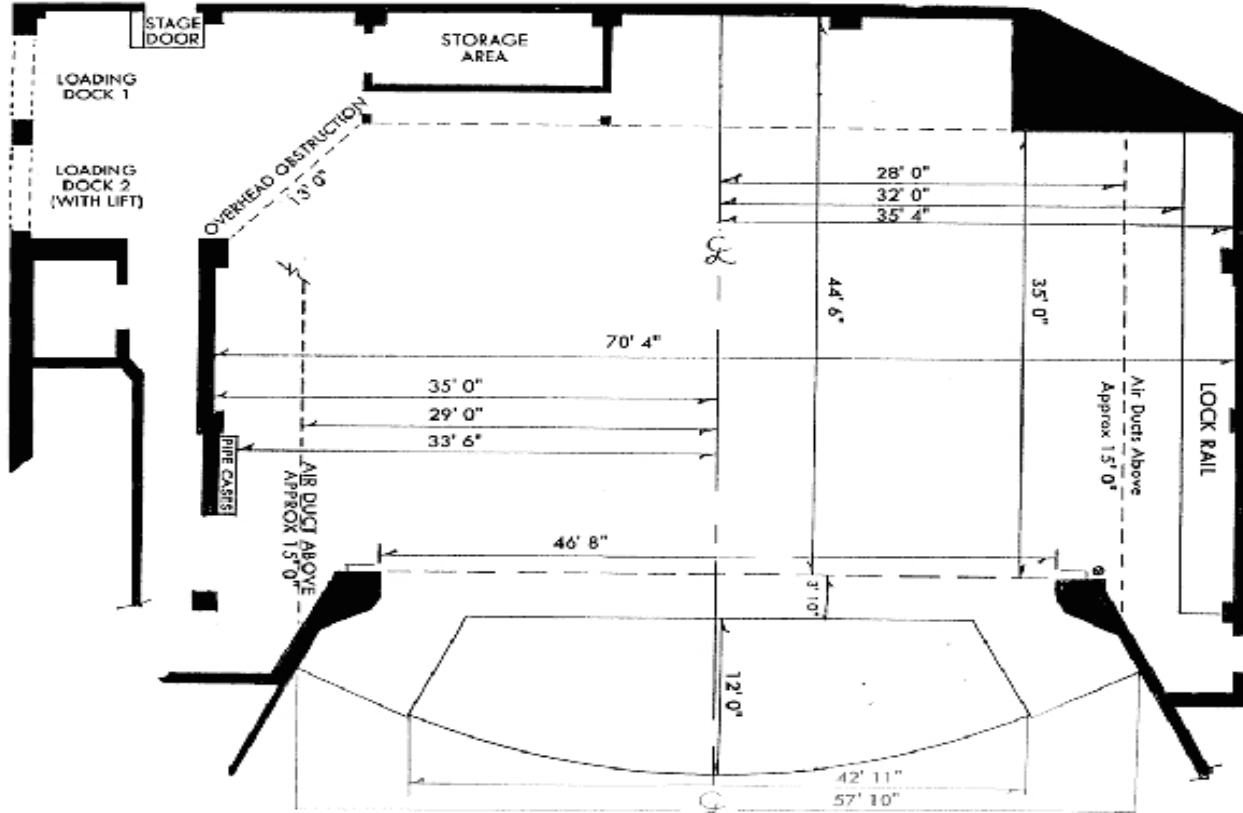

COMMUNITY ARTS CENTER
NOT TO SCALE

HOUSE